

# TEMPERADOS

Catálogo Técnico

Temperados  
V-001

Furação do Vidro para uso da  
Roldana Excêntrica

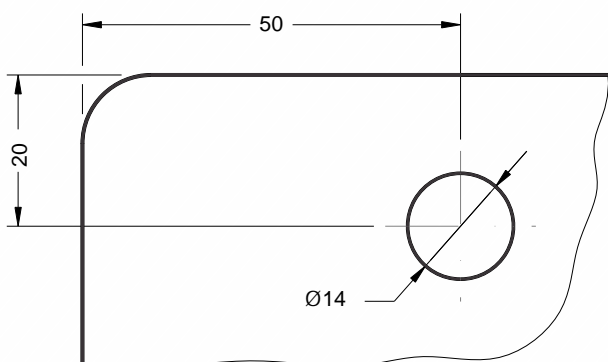

Folgas dos Vidros

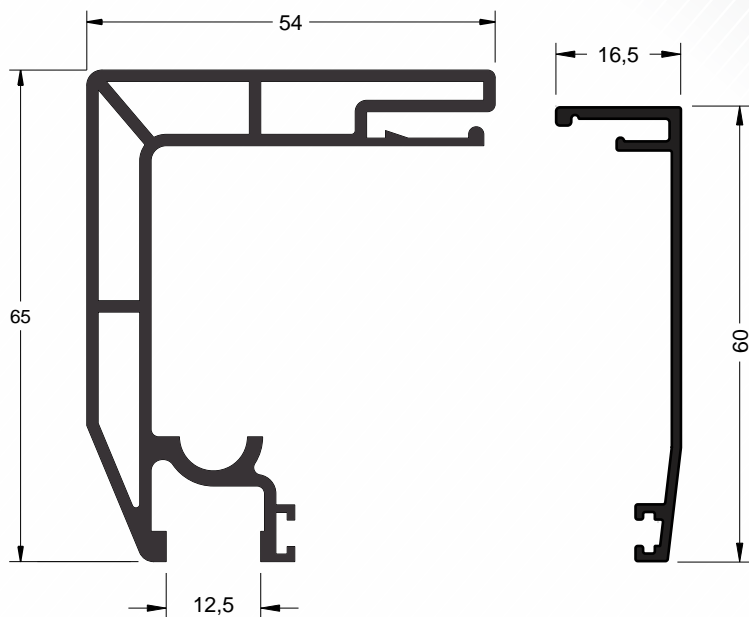
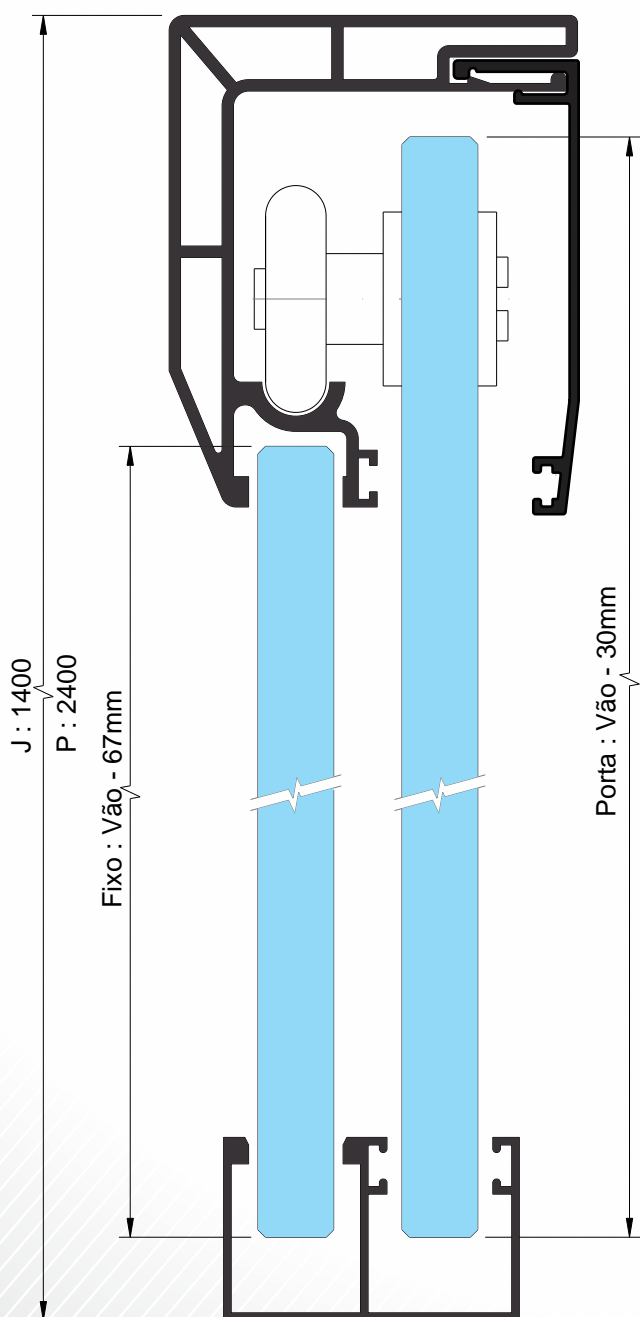

LT-024

Peso : 1.266 Kg/m

LT-047

Peso : 0.318 Kg/m

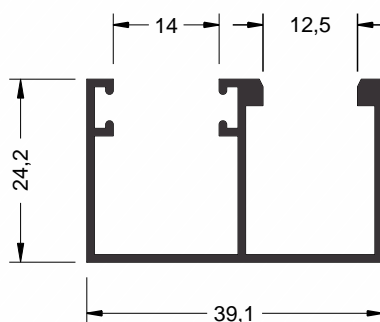

LT-021

Peso : 0.374 Kg/m

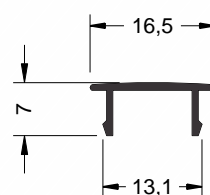

LT-023

Peso : 0.069 Kg/m

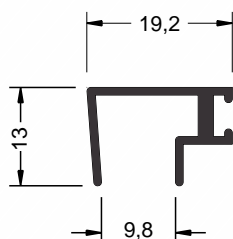

LT-026

Peso : 0.152 Kg/m

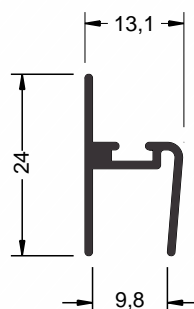

LT-027

Peso : 0.162 Kg/m

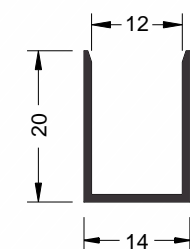

LT-016

Peso : 0.139 Kg/m

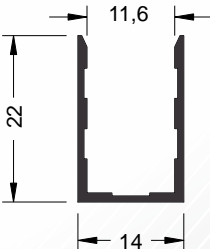

LT-040

Peso : 0.155 Kg/m

Furação do Vidro para uso da  
Roldana Excêntrica

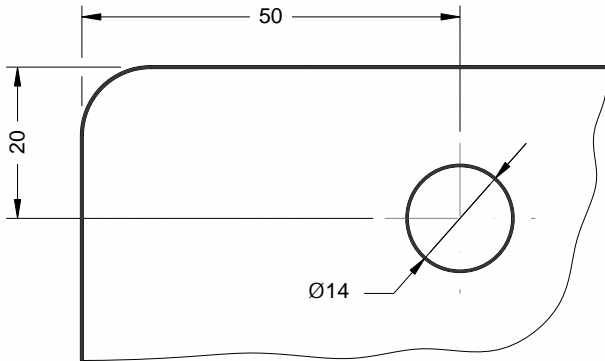

Folgas dos Vidros

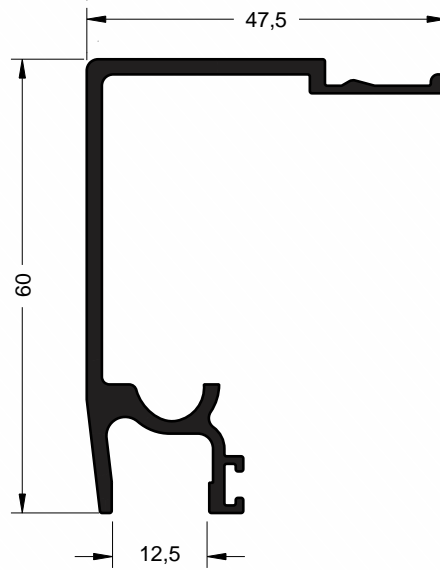
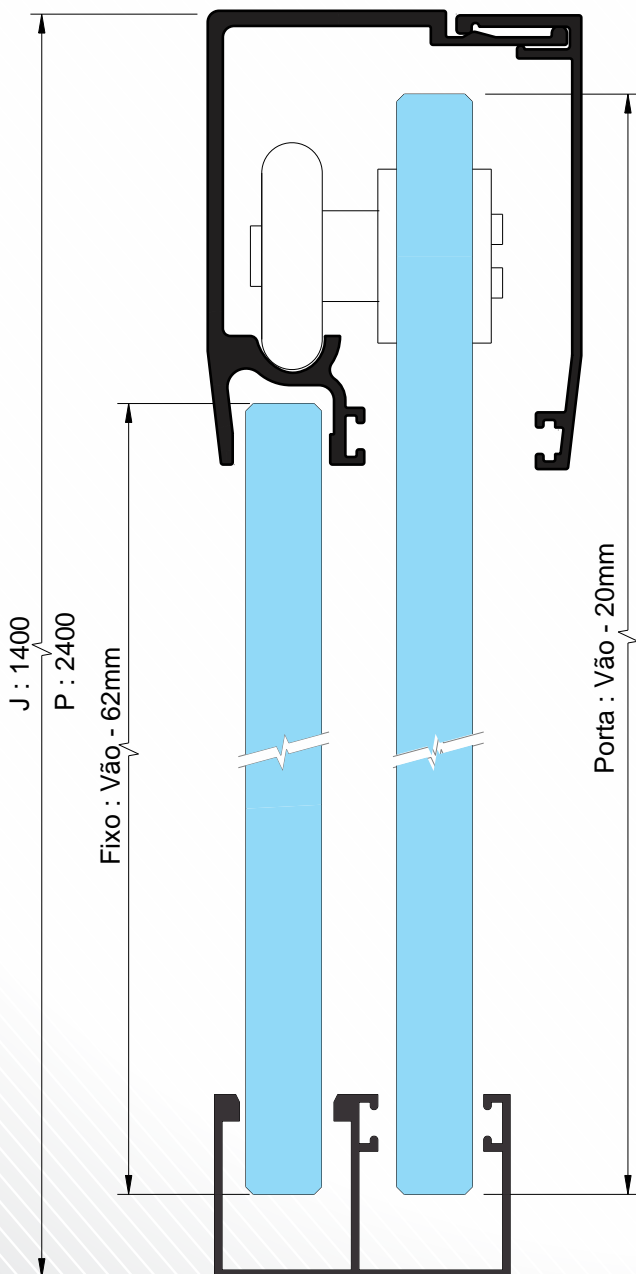

LT-046

Peso : 0.763 Kg/m

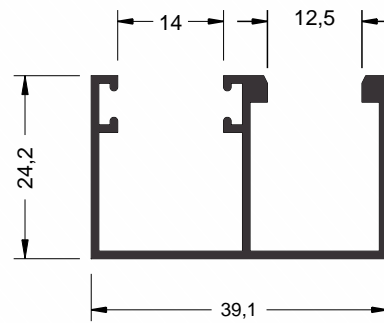

LT-021

Peso : 0.374 Kg/m

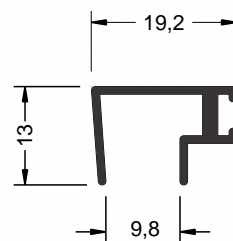

LT-026

Peso : 0.152 Kg/m

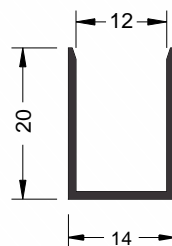

LT-016

Peso : 0.139 Kg/m

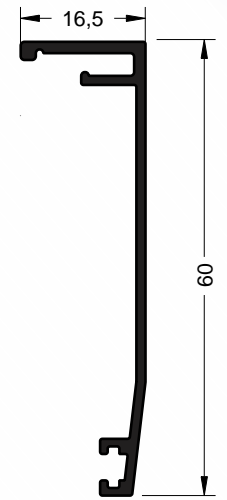

LT-047

Peso : 0.318 Kg/m

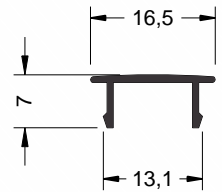

LT-023

Peso : 0.069 Kg/m

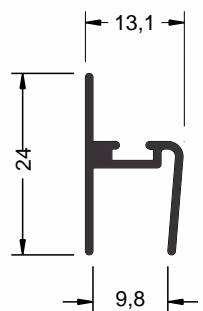

LT-027

Peso : 0.162 Kg/m

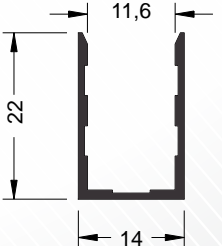

LT-040

Peso : 0.155 Kg/m

Temperados  
V-001

Furação do Vidro para uso das  
Roldanas - 2126D

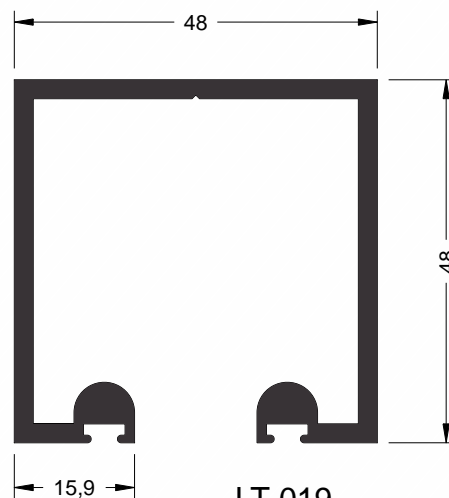
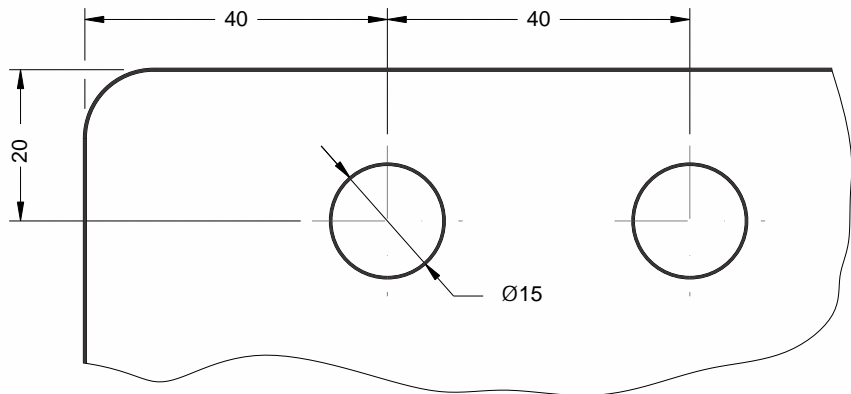

Folgas dos Vidros

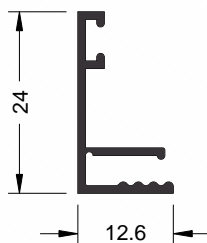
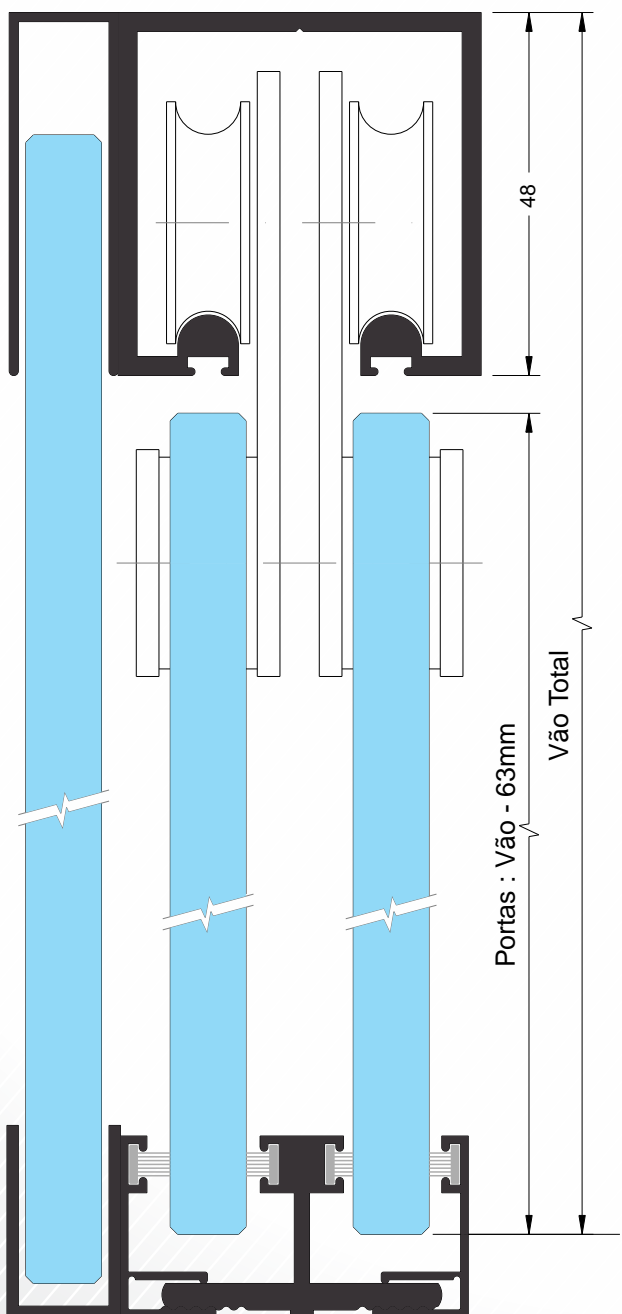

PM-005  
Peso : 0.148 Kg/m

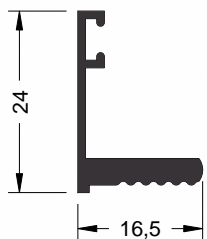

PM-003  
Peso : 0.222 Kg/m

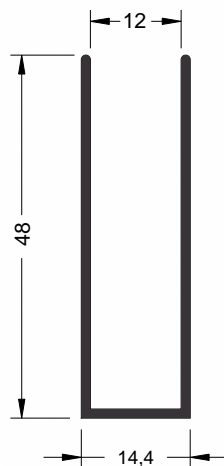

LT-028  
Peso : 0.350 Kg/m

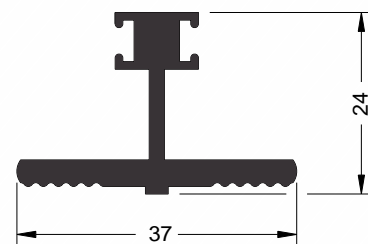

PM-001  
Peso : 0.376 Kg/m

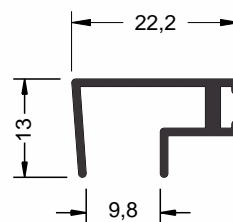

LT-030  
Peso : 0.170 Kg/m

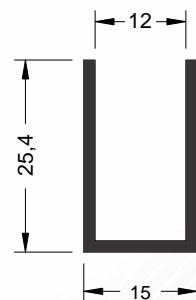

LT-018  
Peso : 0.255 Kg/m

Furação do Vidro para uso da  
Roldana Excêntrica

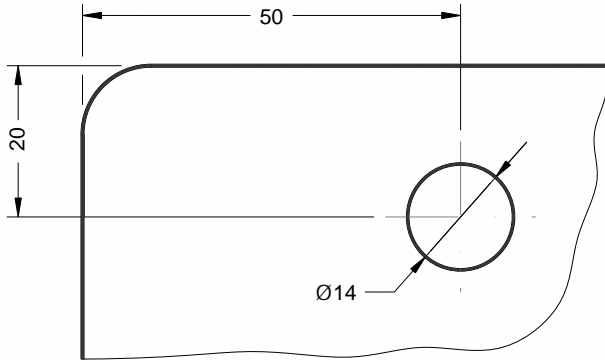

Folgas dos Vidros

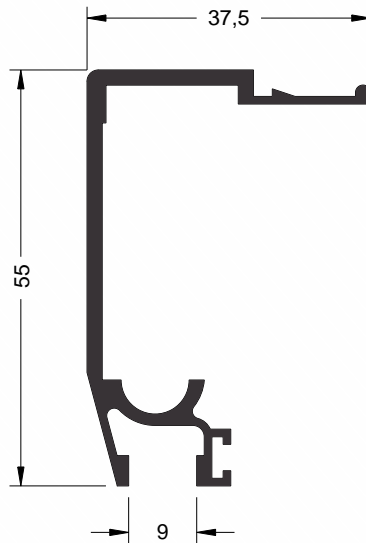
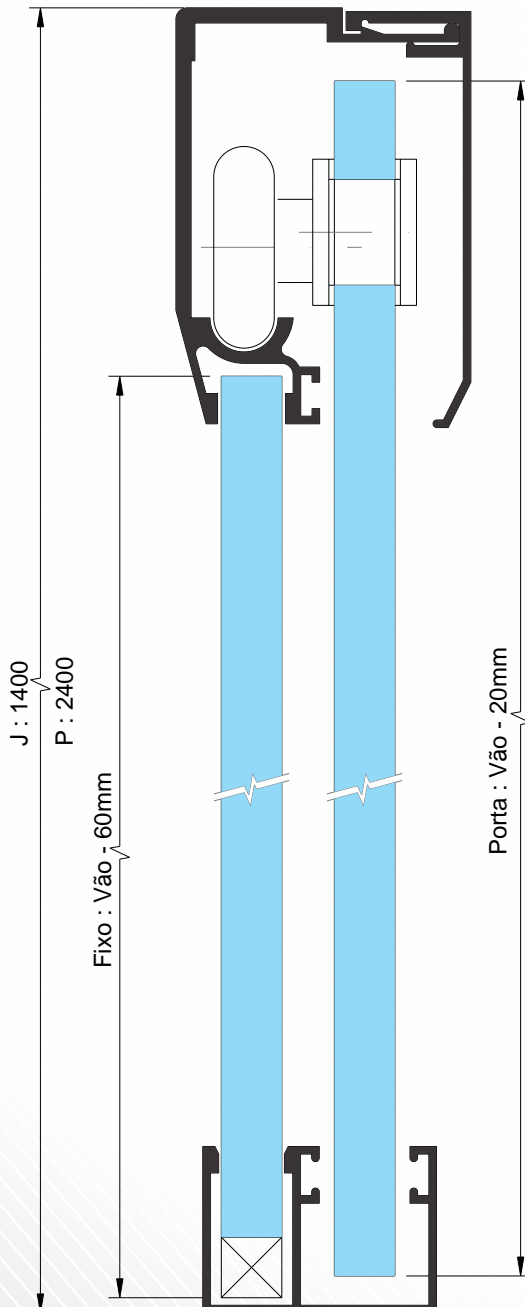

LT-009  
Peso : 0.606 Kg/m

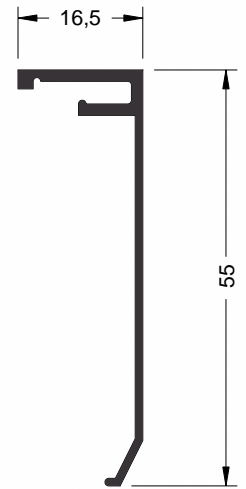

LT-010  
Peso : 0.255 Kg/m

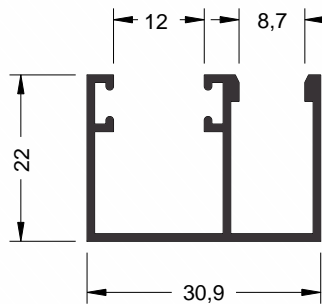

LT-011  
Peso : 0.312 Kg/m

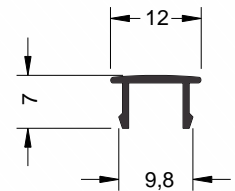

LT-012  
Peso : 0.058 Kg/m

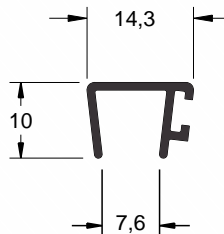

LT-013  
Peso : 0.100 Kg/m

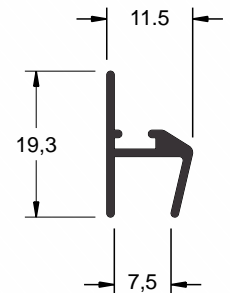

LT-014  
Peso : 0.126 Kg/m

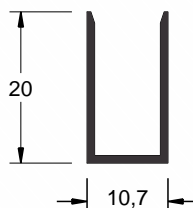

LT-015  
Peso : 0.130 Kg/m

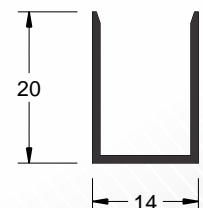

LT-016  
Peso : 0.139 Kg/m

Furação do Vidro para uso da  
Roldana Excêntrica

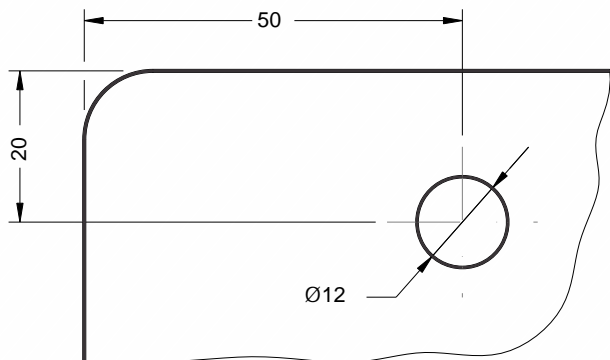

Folgas dos Vidros

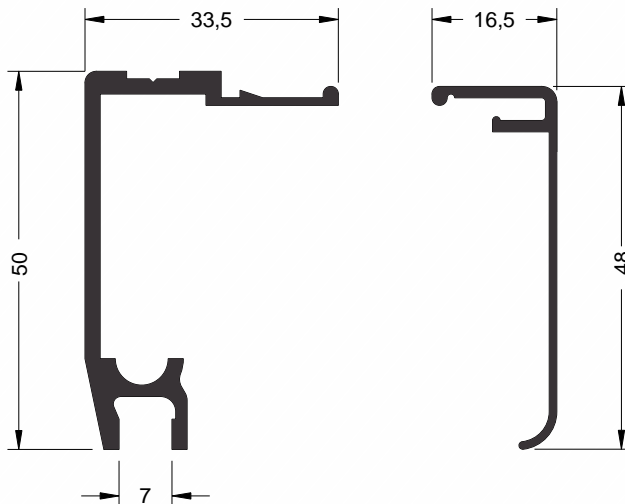
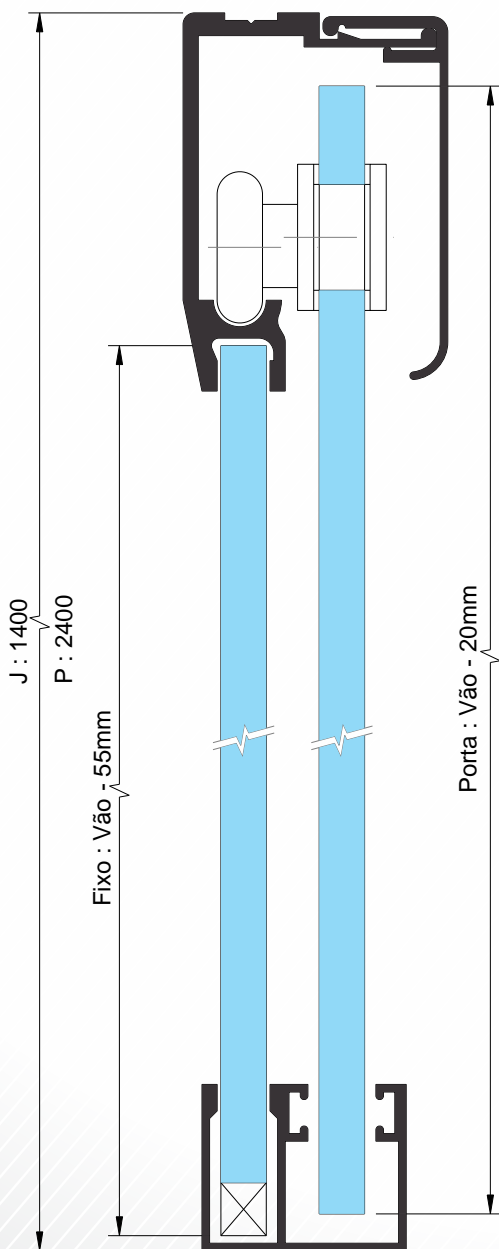

LT-001  
Peso : 0.575 Kg/m

LT-002  
Peso : 0.234 Kg/m

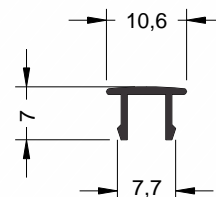
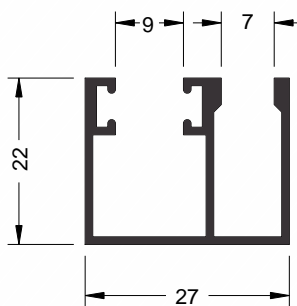

LT-003  
Peso : 0.322 Kg/m

LT-004  
Peso : 0.054 Kg/m

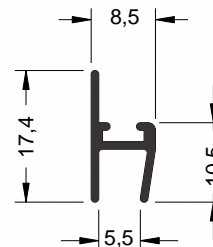
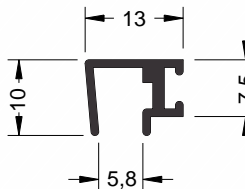

LT-005  
Peso : 0.114 Kg/m

LT-006  
Peso : 0.103 Kg/m

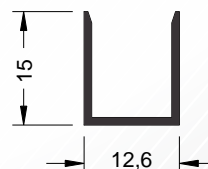
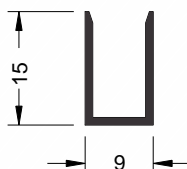

LT-007  
Peso : 0.098 Kg/m

LT-008  
Peso : 0.107 Kg/m

## TIPOLOGIA - Conjunto Engenharia

Porta e Janela de Vidro/Vidro 8mm Curvo	
Código do Perfil	Tipo da Barra
LT-020	Curvada
LT-010	Curvada
LT-023	Curvada
LT-042	Curvada
LT-013	Reta
LT-014	Reta
LT-018	Reta
OBS.: Raio Mínimo - 750mm	

Porta e Janela de Vidro/Alvenaria 8mm Curvo	
Código do Perfil	Tipo da Barra
LT-020	Curvada
LT-010	Curvada
LT-023	Curvada
LT-042	Curvada
LT-013	Reta
LT-015	Reta
LT-016	Reta
OBS.: Raio Mínimo - 750mm	

Porta e Janela de Vidro/Vidro 10mm Curvo	
Código do Perfil	Tipo da Barra
LT-020	Curvada
LT-010	Curvada
LT-023	Curvada
LT-042	Curvada
LT-026	Reta
LT-027	Reta
LT-018	Reta
OBS.: Raio Mínimo - 750mm	

Porta e Janela de Vidro/Alvenaria 10mm Curvo	
Código do Perfil	Tipo da Barra
LT-020	Curvada
LT-010	Curvada
LT-023	Curvada
LT-042	Curvada
LT-026	Reta
LT-016	Reta
LT-018	Reta
OBS.: Raio Mínimo - 750mm	

Porta e Janela de Vidro/Vidro 8mm Curvo		
	Código do Perfil	Tipo da Barra
Opção Nº 1	LT-019	Curvada
	PM-001	Curvada
	PM-003	Curvada
	PM-005	Curvada
	LT-018	Curvada
	LT-013	Reta
	LT-014	Reta
	LT-015	Reta
Raio Mínimo 7000mm, Menor sob consulta.		

Porta e Janela de Vidro/Vidro 10mm Curvo		
	Código do Perfil	Tipo da Barra
Opção Nº 1	LT-019	Curvada
	PM-001	Curvada
	PM-003	Curvada
	PM-005	Curvada
	LT-018	Reta
	LT-030	Reta
	LT-027	Reta
Raio Mínimo 7000mm, Menor sob consulta.		

Porta e Janela de Vidro/Vidro 8mm Curvo		
	Código do Perfil	Tipo da Barra
Opção Nº 2	LT-019	Curvada
	LT-043	Curvada
	LT-018	Curvada
	LT-013	Reta
	LT-014	Reta
	LT-015	Reta
Raio Mínimo 7000mm, Menor sob consulta.		

Porta e Janela de Vidro/Vidro 10mm Curvo			
	Código do Perfil	Tipo da Barra	
Opção Nº 2	LT-019	Curvada	
	LT-043	Curvada	
	LT-018	Curvada	
	LT-030	Reta	
	LT-027	Reta	
Raio Mínimo 7000mm, Menor sob consulta.			

Porta e Janela de Vidro/Vidro 8mm Curvo		
	Código do Perfil	Tipo da Barra
Opção Nº 3	LT-019	Curvada
	LT-017	Curvada
	LT-018	Curvada
	LT-013	Reta
	LT-014	Reta
	LT-015	Reta
Raio Mínimo 7000mm, Menor sob consulta.		

Porta e Janela de Vidro/Vidro 10mm Curvo		
	Código do Perfil	Tipo da Barra
Opção Nº 3	LT-019	Curvada
	LT-017	Curvada
	LT-018	Curvada
	LT-030	Reta
	LT-027	Reta
Raio Mínimo 7000mm, Menor sob consulta.		



## RELAÇÃO DE PERFIS CURVOS (EM BARRA)

Código do Perfil	Acabamento do Perfil		Raio Mínimo p/ Curvatura
	Pintado	Natural	
LT-009	OK		750mm
LT-010	OK		750mm
LT-011	OK		750mm
LT-012	OK		750mm
LT-016	OK		750mm
LT-017	OK		750mm
LT-018	OK		750mm
LT-019		OK	Sob Consulta
LT-020	OK		750mm
LT-021	OK		750mm
LT-023	OK		750mm
LT-042		OK	750mm
LT-043		OK	750mm
TD-011		OK	1000mm
TD-012		OK	1000mm
TD-013		OK	1000mm
TD-014		OK	1000mm
TD-015		OK	Sob Consulta
TR-018	OK		750mm
TR-070	OK		750mm
TR-099	OK		750mm
TR-135	OK		1500mm
TR-162	OK		1500mm
TQ-100	OK		750mm
BT-014	OK		750mm

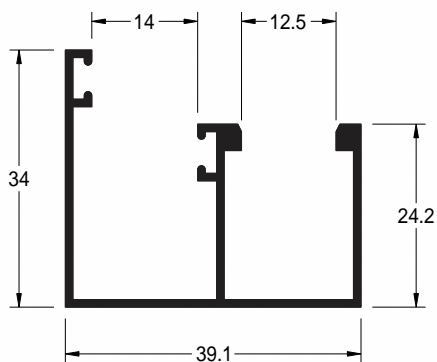

LT-022

Trilho Duplo Inferior

Peso (Kg/m)	Superfície (mm <sup>2</sup> /mm)		Inércia (mm <sup>2</sup> /mm)	
	Área	Perímetro	Jx mm <sup>4</sup>	Jy mm <sup>4</sup>
0,398	147.67	273.71	15767.21	29713.58

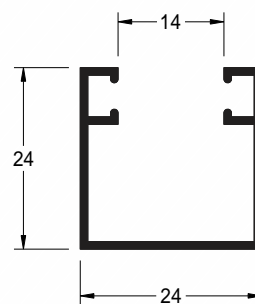

LT-017

Trilho Simples Inferior

Peso (Kg/m)	Superfície (mm <sup>2</sup> /mm)		Inércia (mm <sup>2</sup> /mm)	
	Área	Perímetro	Jx mm <sup>4</sup>	Jy mm <sup>4</sup>
0,241	89.57	180.28	6643.24	8757.78

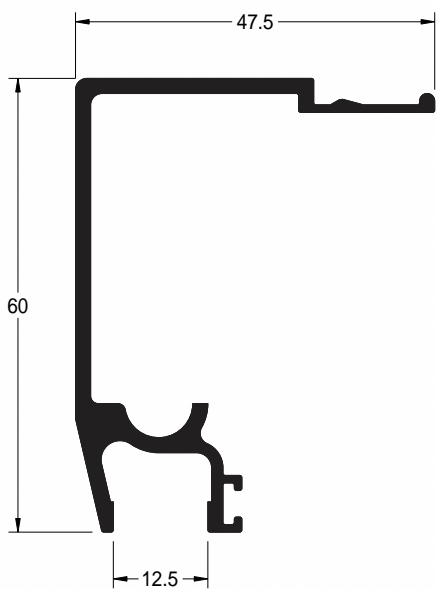

LT-020

Trilho Superior

Peso (Kg/m)	Superfície (mm <sup>2</sup> /mm)		Inércia (mm <sup>2</sup> /mm)	
	Área	Perímetro	Jx mm <sup>4</sup>	Jy mm <sup>4</sup>
0,780	288.69	292.41	134137.04	40271.97

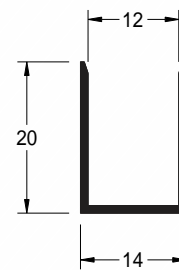

LT-025

Perfil "U" - Arremate

Peso (Kg/m)	Superfície (mm <sup>2</sup> /mm)		Inércia (mm <sup>2</sup> /mm)	
	Área	Perímetro	Jx mm <sup>4</sup>	Jy mm <sup>4</sup>
0,138	51.25	105.16	2063.28	1808.80

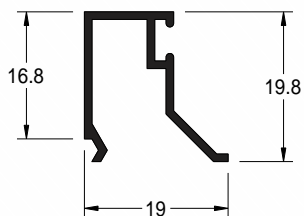

LT-031

Baguete

Peso (Kg/m)	Superfície (mm <sup>2</sup> /mml)		Inércia (mm <sup>2</sup> /mml)	
	Área	Perímetro	Jx mm <sup>4</sup>	Jy mm <sup>4</sup>
0,159	58.99	118.71	2464.38	1826.64

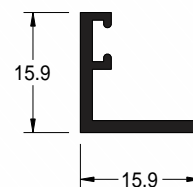

LT-032

Guia

Peso (Kg/m)	Superfície (mm <sup>2</sup> /mml)		Inércia (mm <sup>2</sup> /mml)	
	Área	Perímetro	Jx mm <sup>4</sup>	Jy mm <sup>4</sup>
0,147	54.45	76.64	1542.13	1155.86

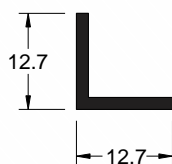

LT-033

Cantoneira de Arremate

Peso (Kg/m)	Superfície (mm <sup>2</sup> /mml)		Inércia (mm <sup>2</sup> /mml)	
	Área	Perímetro	Jx mm <sup>4</sup>	Jy mm <sup>4</sup>
0,102	37.63	50.80	562.94	562.94

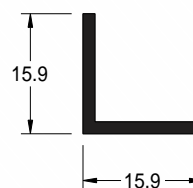

LT-034

Cantoneira de Arremate

Peso (Kg/m)	Superfície (mm <sup>2</sup> /mml)		Inércia (mm <sup>2</sup> /mml)	
	Área	Perímetro	Jx mm <sup>4</sup>	Jy mm <sup>4</sup>
0,128	47.66	63.50	1138.60	1138.60

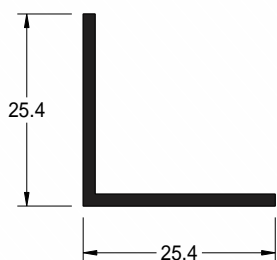

LT-035

Cantoneira de Arremate

Peso (Kg/m)	Superfície (mm <sup>2</sup> /mml)		Inércia (mm <sup>2</sup> /mml)	
	Área	Perímetro	Jx mm <sup>4</sup>	Jy mm <sup>4</sup>
0,210	77.76	101.60	4920.41	4920.41

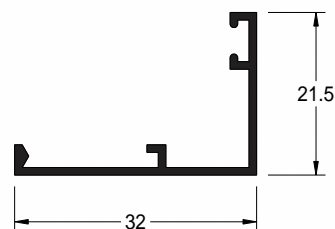

LT-036

Quadro do Baguete

Peso (Kg/m)	Superfície (mm <sup>2</sup> /mml)		Inércia (mm <sup>2</sup> /mml)	
	Área	Perímetro	Jx mm <sup>4</sup>	Jy mm <sup>4</sup>
0,104	68.08	135.60	3352.38	8072.19

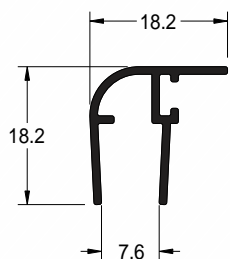

LT-039

Arremate

Peso (Kg/m)	Superfície (mm <sup>2</sup> /mml)		Inércia (mm <sup>2</sup> /mml)	
	Área	Perímetro	Jx mm <sup>4</sup>	Jy mm <sup>4</sup>
0,153	56.66	112.67	1737.23	1358.55

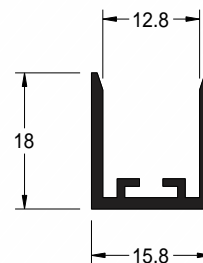

LT-048

Guia Batente

Peso (Kg/m)	Superfície (mm <sup>2</sup> /mml)		Inércia (mm <sup>2</sup> /mml)	
	Área	Perímetro	Jx mm <sup>4</sup>	Jy mm <sup>4</sup>
0,217	80.41	117.14	2339.59	3064.72

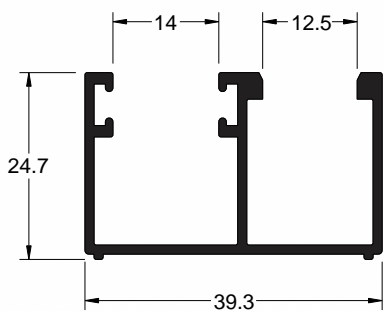

LT-042

Trilho Duplo Inferior

Peso (Kg/m)	Superfície (mm <sup>2</sup> /mml)		Inércia (mm <sup>2</sup> /mml)	
	Área	Perímetro	Jx mm <sup>4</sup>	Jy mm <sup>4</sup>
0,442	163.50	252.02	12466.07	31372.20

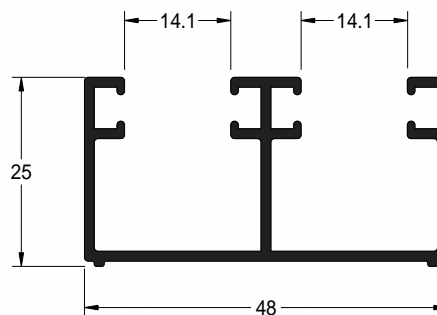

LT-043

Trilho Duplo Inferior

Peso (Kg/m)	Superfície (mm <sup>2</sup> /mml)		Inércia (mm <sup>2</sup> /mml)	
	Área	Perímetro	Jx mm <sup>4</sup>	Jy mm <sup>4</sup>
0,547	202.33	311.07	15790.92	55882.11

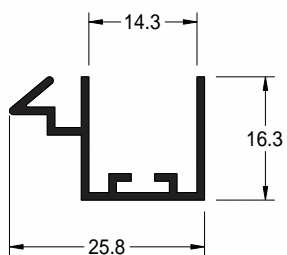

LT-044

Guia Batente

Peso (Kg/m)	Superfície (mm <sup>2</sup> /mml)		Inércia (mm <sup>2</sup> /mml)	
	Área	Perímetro	Jx mm <sup>4</sup>	Jy mm <sup>4</sup>
0,200	73.81	147.91	2035.74	4736.71

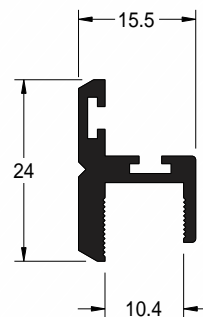

LT-052

Frizo Batente Vertical

Peso (Kg/m)	Superfície (mm <sup>2</sup> /mml)		Inércia (mm <sup>2</sup> /mml)	
	Área	Perímetro	Jx mm <sup>4</sup>	Jy mm <sup>4</sup>
0,303	112.29	117.96	3380.55	3044.37

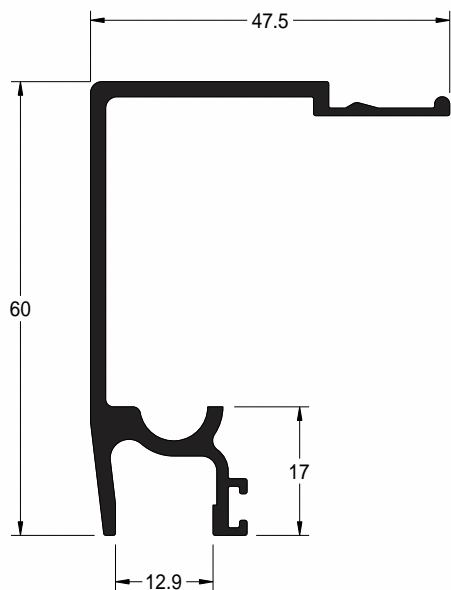

**LT-046**

**Trilho Superior**

Peso (Kg/m)	Superfície (mm <sup>2</sup> /mml)		Inércia (mm <sup>2</sup> /mml)	
	Área	Perímetro	Jx mm <sup>4</sup>	Jy mm <sup>4</sup>
0,764	282.77	291.47	131023.16	39947.39

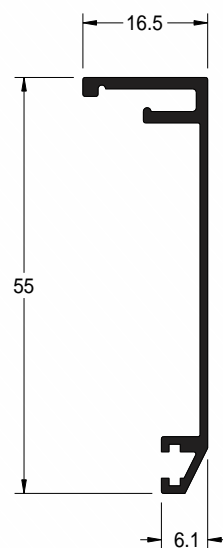

**LT-041**

**Capa do Trilho Superior**

Peso (Kg/m)	Superfície (mm <sup>2</sup> /mml)		Inércia (mm <sup>2</sup> /mml)	
	Área	Perímetro	Jx mm <sup>4</sup>	Jy mm <sup>4</sup>
0,286	105.88	178.30	40702.46	1924.15

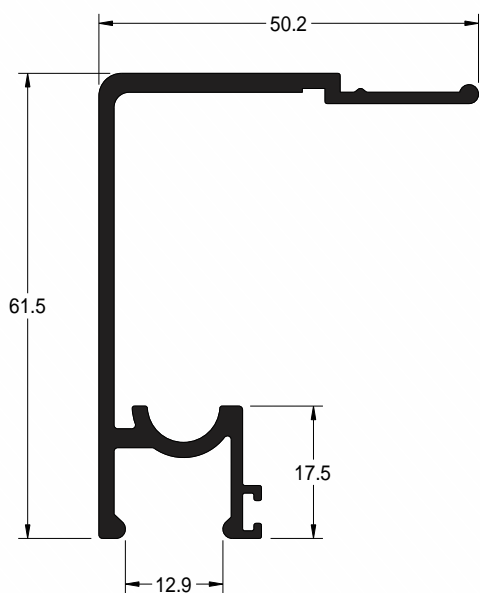

**LT-049**

**Trilho Superior**

Peso (Kg/m)	Superfície (mm <sup>2</sup> /mml)		Inércia (mm <sup>2</sup> /mml)	
	Área	Perímetro	Jx mm <sup>4</sup>	Jy mm <sup>4</sup>
0,843	312.46	311.87	157892.01	52193.15

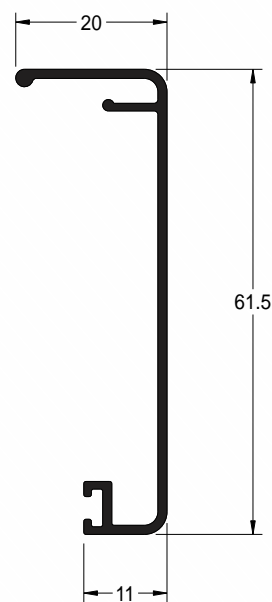

**LT-050**

**Capa do Trilho Superior**

Peso (Kg/m)	Superfície (mm <sup>2</sup> /mml)		Inércia (mm <sup>2</sup> /mml)	
	Área	Perímetro	Jx mm <sup>4</sup>	Jy mm <sup>4</sup>
0,340	126.07	212.36	65552.81	3284.62

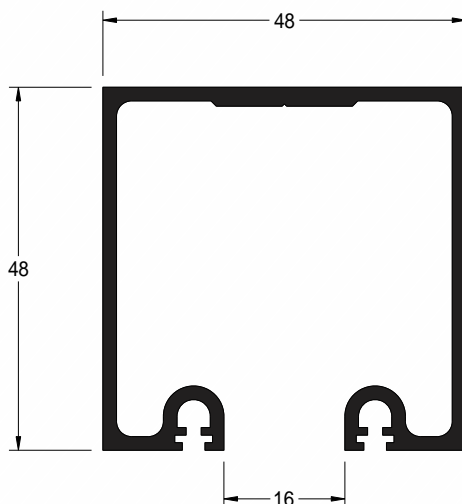

LT-051

Trilho Superior

Peso (Kg/m)	Superfície (mm <sup>2</sup> /mml)		Inércia (mm <sup>2</sup> /mml)	
	Área	Perímetro	Jx mm <sup>4</sup>	Jy mm <sup>4</sup>
0,996	367.65	396.23	125651.95	127224.25



LT-045

Guia

Peso (Kg/m)	Superfície (mm <sup>2</sup> /mml)		Inércia (mm <sup>2</sup> /mml)	
	Área	Perímetro	Jx mm <sup>4</sup>	Jy mm <sup>4</sup>
0,445	164.81	216.34	24395.94	70816.07

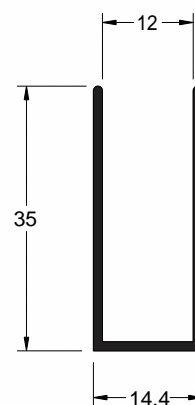

LT-029

Perfil "U" - Arremate

Peso (Kg/m)	Superfície (mm <sup>2</sup> /mml)		Inércia (mm <sup>2</sup> /mml)	
	Área	Perímetro	Jx mm <sup>4</sup>	Jy mm <sup>4</sup>
0,265	98.09	165.36	11965.62	3828.38

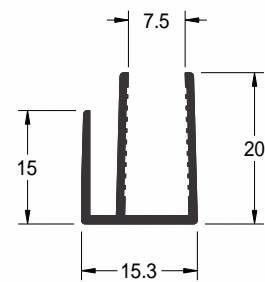
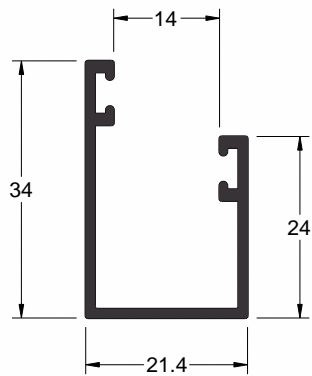

LT-053

Trilho Inferior Simples

Peso (Kg/m)	Superfície (mm <sup>2</sup> /mml)		Inércia (mm <sup>2</sup> /mml)	
	Área	Perímetro	Jx mm <sup>4</sup>	Jy mm <sup>4</sup>
0,299	110.85	181.39	12668.63	8882.35

LT-054

Mão de Amigo p/ vidro 8mm

Peso (Kg/m)	Superfície (mm <sup>2</sup> /mml)		Inércia (mm <sup>2</sup> /mml)	
	Área	Perímetro	Jx mm <sup>4</sup>	Jy mm <sup>4</sup>
0,184	68.05	142.93	2516.67	2005.00

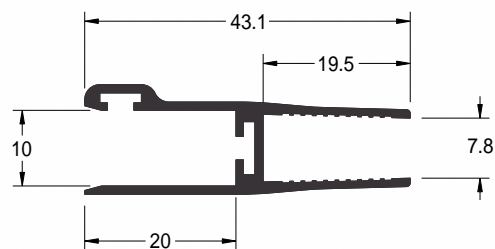

LT-055

Folha de União p/ vidro 8mm

Peso (Kg/m)	Superfície (mm <sup>2</sup> /mml)		Inércia (mm <sup>2</sup> /mml)	
	Área	Perímetro	Jx mm <sup>4</sup>	Jy mm <sup>4</sup>
0,336	124.53	218.71	3408.60	16129.10

### TIPOLOGIA LINHA BOX STANDARD - CURVO

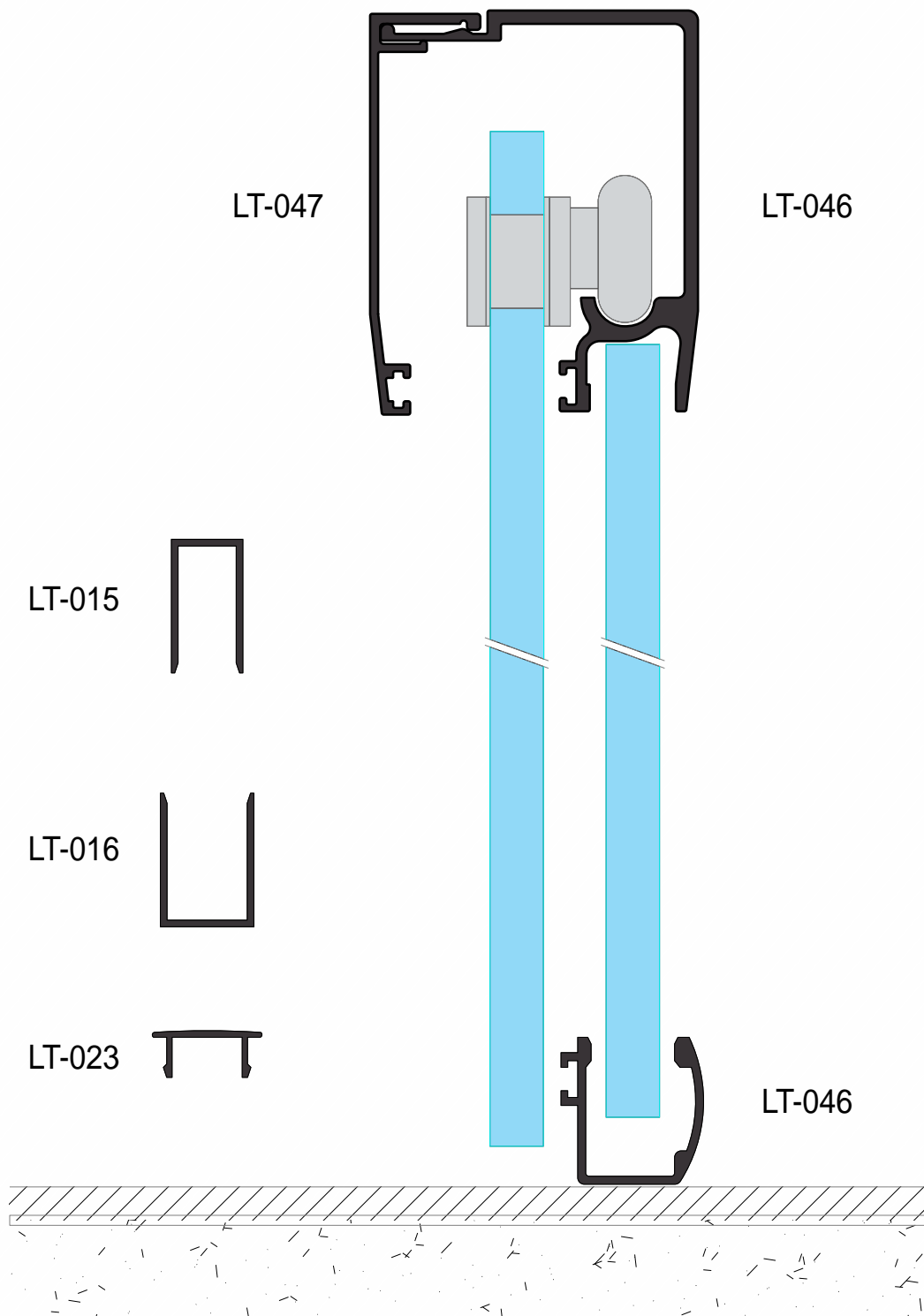

**BOX TEMPERADO CURVO  
LINHA CONVENCIONAL  
8mm**



TIPOLOGIA  
LINHA BOX STANDARD

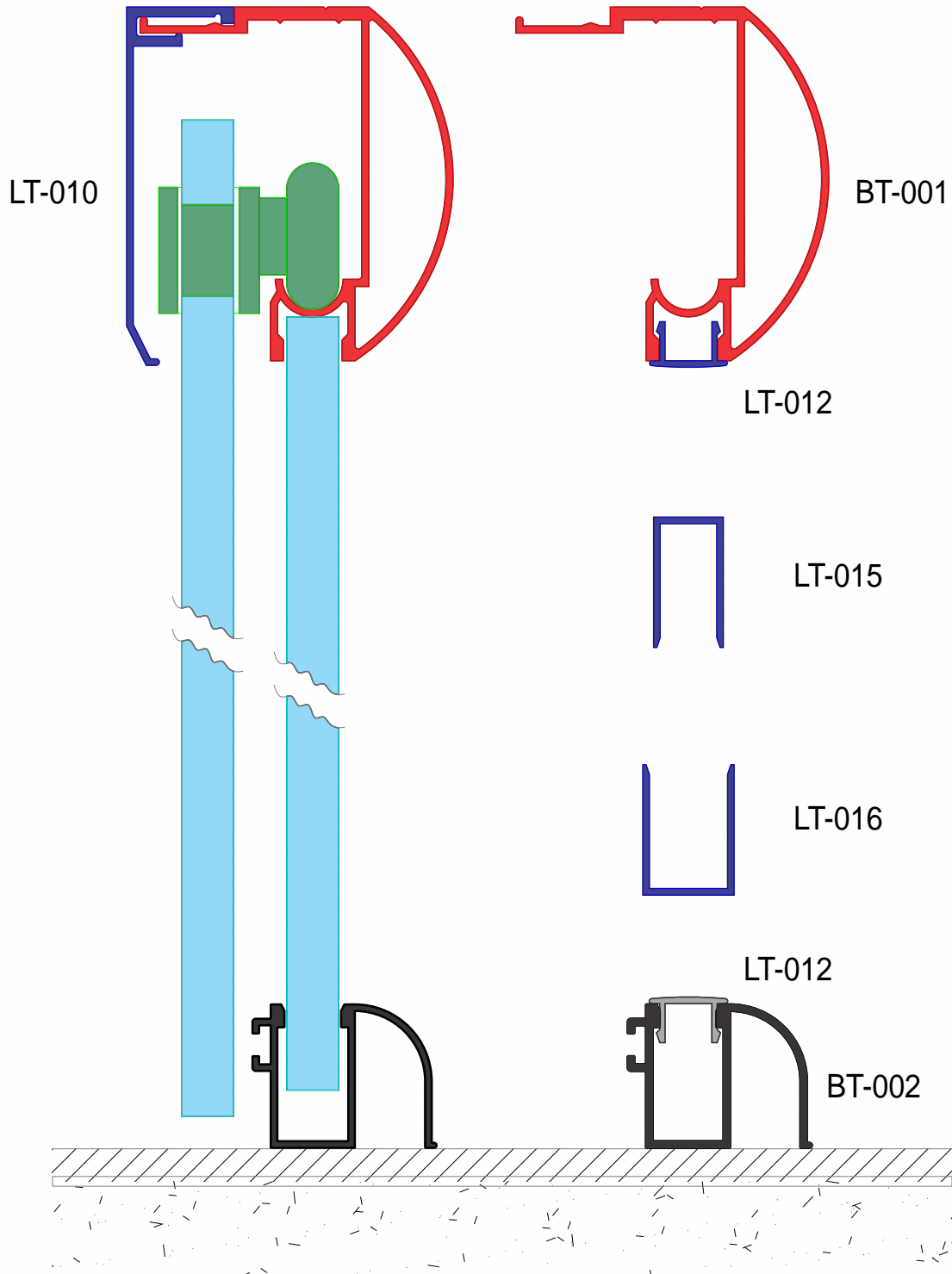

BOX TEMPERADO  
LINHA CONVENCIONAL  
8mm

### TIPOLOGIA LINHA BOX STANDARD

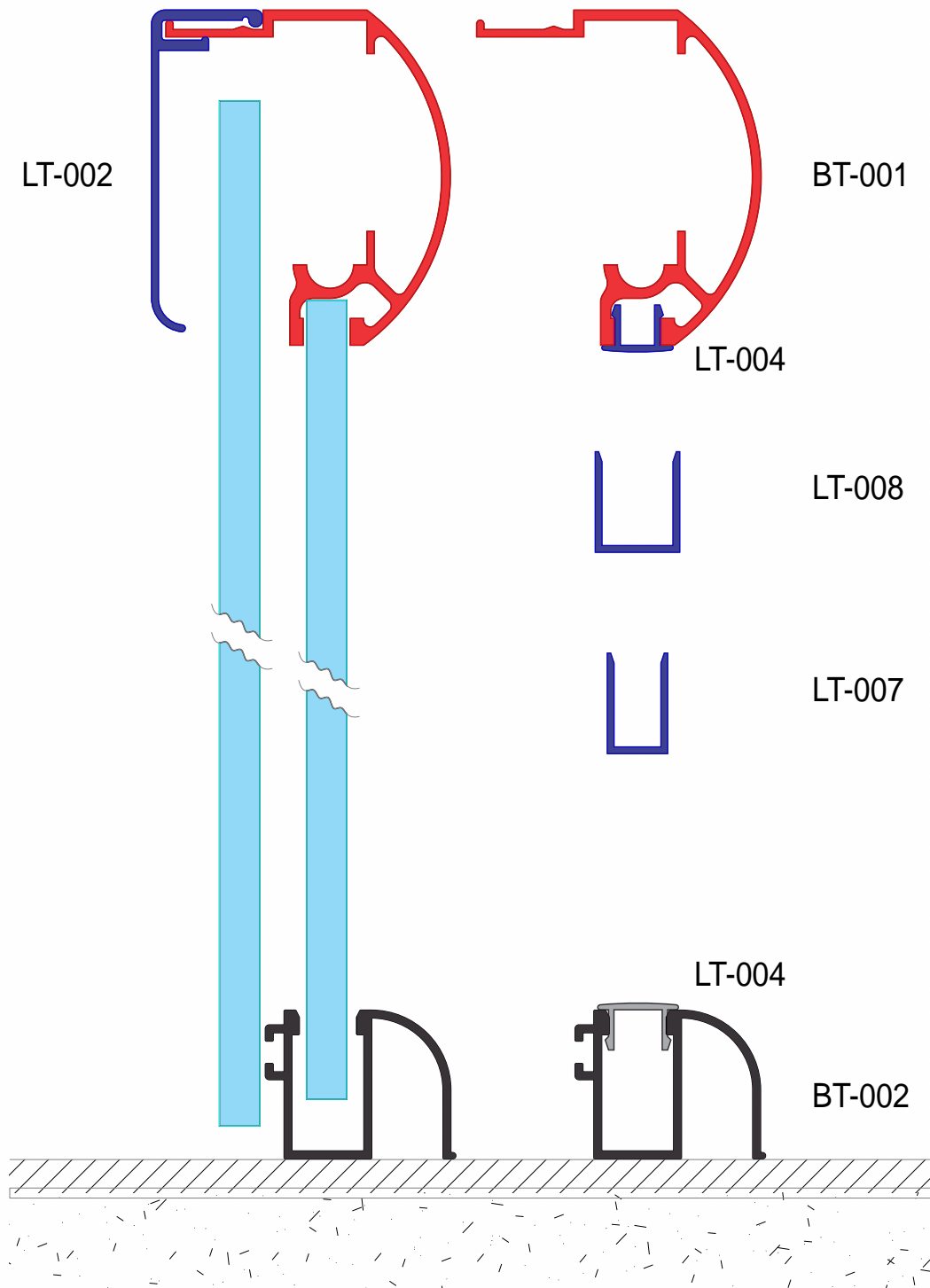

**BOX TEMPERADO CURVO**  
6mm

### TIPOLOGIA LINHA BOX STANDARD

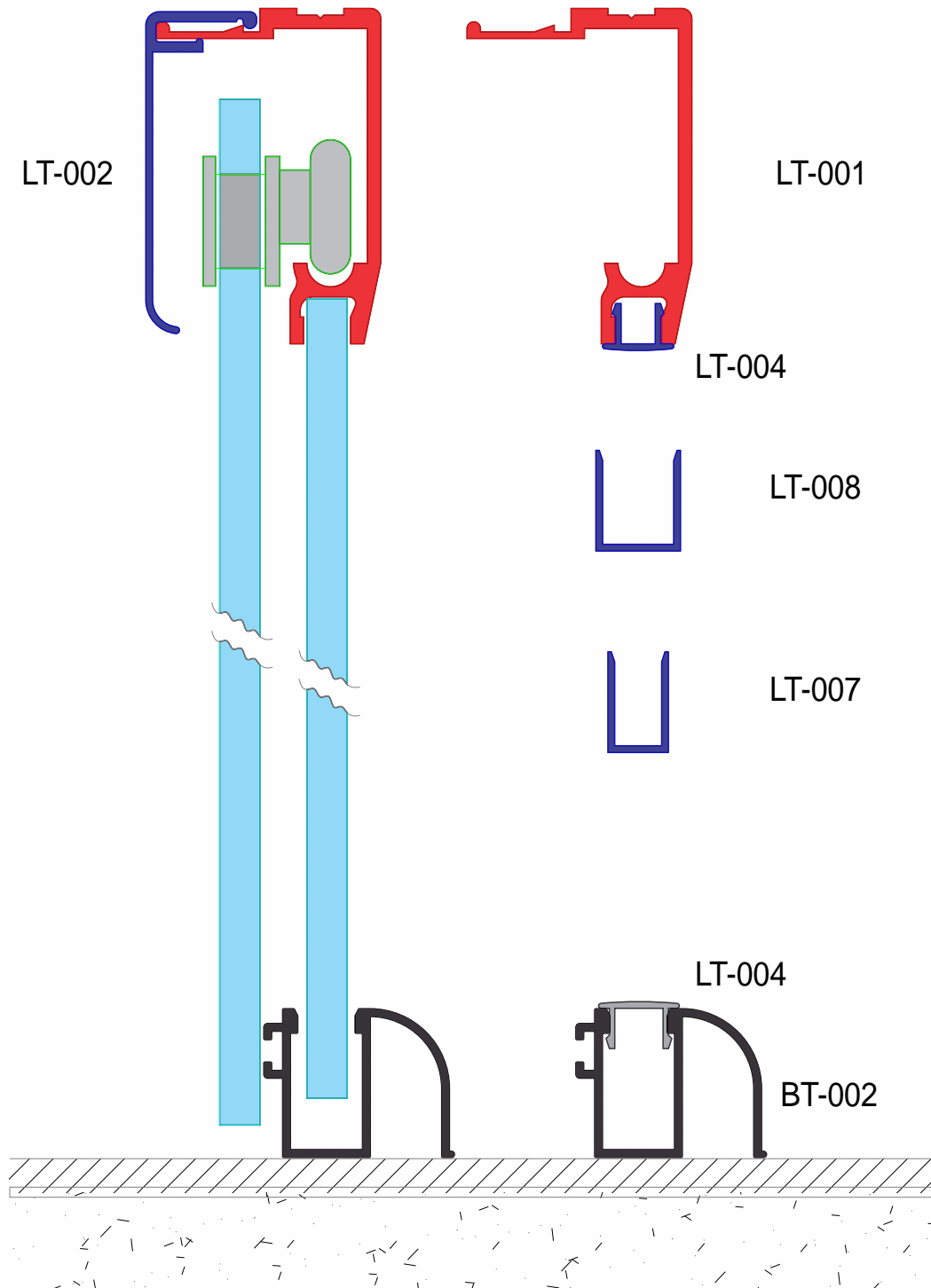

**BOX TEMPERADO RETO**  
6mm

### TIPOLOGIA LINHA BOX STANDARD

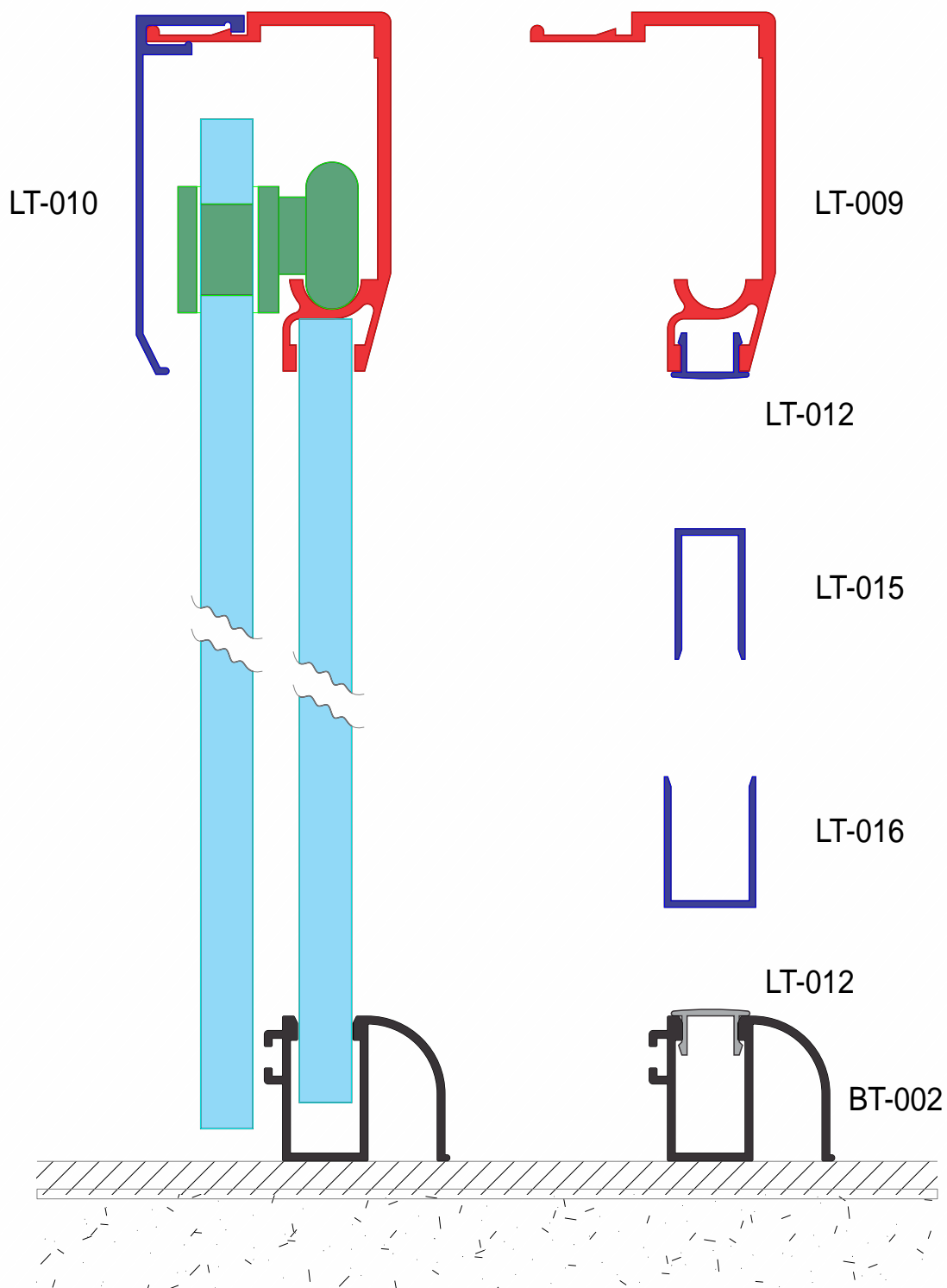

**BOX TEMPERADO RETO**  
8mm

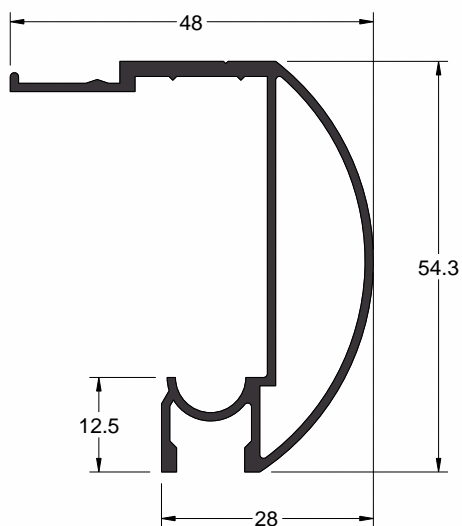

**BT-001**

**Trilho Superior Móvel**

Peso (Kg/m)	Superfície (mm <sup>2</sup> /mm)		Inércia (mm <sup>2</sup> /mm)	
	Área	Perímetro	Jx mm <sup>4</sup>	Jy mm <sup>4</sup>
0,615	227.80	359.95	86235.17	28293.04

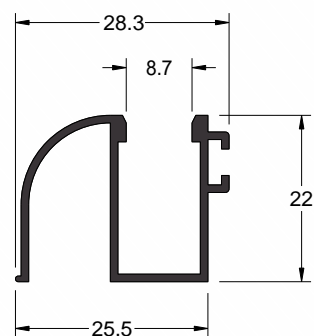

**BT-002**

**Trilho Inferior**

Peso (Kg/m)	Superfície (mm <sup>2</sup> /mm)		Inércia (mm <sup>2</sup> /mm)	
	Área	Perímetro	Jx mm <sup>4</sup>	Jy mm <sup>4</sup>
0,266	98.54	188.28	5281.14	7913.69

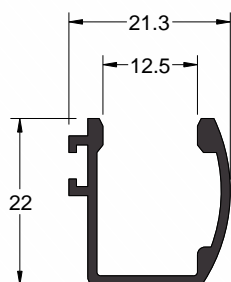

**BT-014**

**Tampa do Trilho Superior**

Peso (Kg/m)	Superfície (mm <sup>2</sup> /mm)		Inércia (mm <sup>2</sup> /mm)	
	Área	Perímetro	Jx mm <sup>4</sup>	Jy mm <sup>4</sup>
0,245	91.06	135.37	5038.60	5432.09

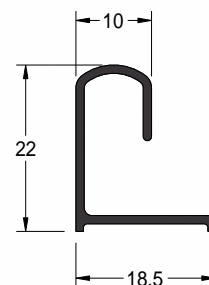

**BT-011**

**Guia Inferior**

Peso (Kg/m)	Superfície (mm <sup>2</sup> /mm)		Inércia (mm <sup>2</sup> /mm)	
	Área	Perímetro	Jx mm <sup>4</sup>	Jy mm <sup>4</sup>
0.164	60.66	111.10	3739.80	1696.14

